

### 1. Preparation

- This short instruction is only to visualize the main steps and does not replace the full mounting instruction. The full mounting instruction has to be read and understood completely.

**Note!!!**

Please follow these guidelines:

- Accident prevention regulations
- Truck manufacturers rules
- MBB mounting drawing
- Operators manual

**Truck preparation**

Dismount disturbing chassis parts. Body end traverse must be extra reinforced to hold up the forces of the lift (Fig. 1) Consider a seal kit before Mounting (if applicable). For mounting behind swing doors, please refer to the full mounting instructions.

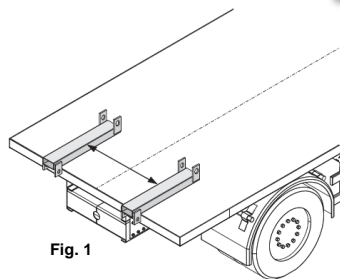

### 2. Lift gear mounting

- Mount the tail lift according to **MBB recommended install drawing**. Use the **mounting jigs** at the liftarm and bring the arms up to bed height. Use clamps for safety (Fig. 4)
- Drill **chassis holes** (Fig. 4)

C 350 L	- C 1000 L	4 ea./plate. Bolt: M14 x 1,5
C 1000 S	- C 1500 L	6 ea./plate. Bolt: M14 x 1,5
C 1500 S	- C 2500 L	10 ea./plate. Bolt M14 x 1,5
C 2500 S	- C 3000 S	14 ea./plate. Bolt M14 x 1,5

**Note!!! Bolted mount plates (Fig. 2)**

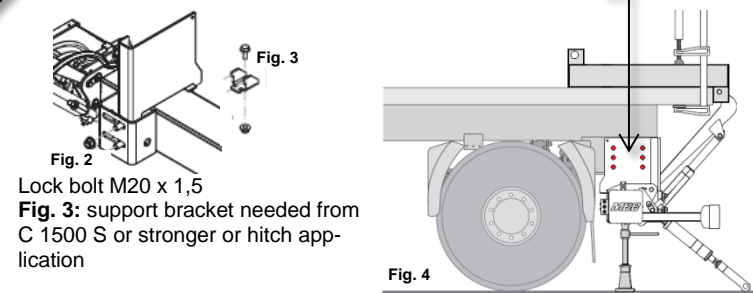

**Torque**  
M14 x 1,5 => 190 Nm  
M20 x 1,5 => 400 Nm

### 3. Make lift operational

- Connect **plus and minus cable** at designated battery (Fig. 5)
- If applicable, connect standardized on-off-interface to truck (VEHH Code A) or use PALFINGER **cab switch** (Fig. 6)
- Install operators box
- Replace transport cap with air filter if needed (Fig. 7)

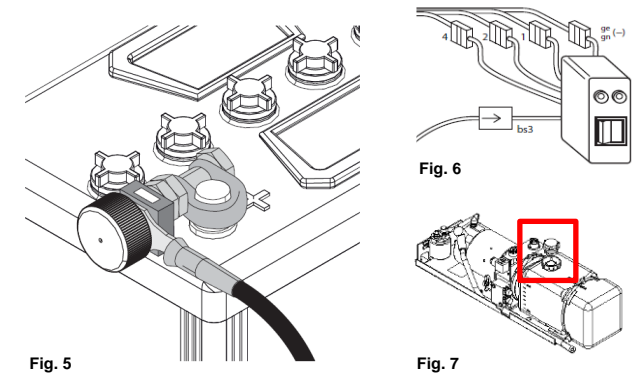

### 6. Check off sheet

- ✓ All mounting bolts tight
- ✓ If applic.: air filter installed
- ✓ Oil level check performed
- ✓ All hoses can move free (no rubbing/stretch)
- ✓ Wire routing ok (strain relief!)
- ✓ Multiple lift cycles performed with max loading weight
- ✓ Automatic ground levelling ok
- ✓ Automatic horizontal levelling at ground ok
- ✓ Optional: Foot control function check
- ✓ Optional: Warning lights
- ✓ Optional: multiple hand control devices
- ✓ Optional: Warning flaggs
- ✓ Misuse by third parties provided (i.e. cab switch)
- ✓ Serial tag at platform installed
- ✓ Next routine check batch installed
- ✓ Control booklet filed



### 5. Last steps

- Adjust **tilt cylinder** in a way, that the platform rests against the box/body. Cylinder must be parallel. To avoid twisting piston rods, open platform slightly and tighten counter nuts for the clevis (Fig. 10)
- Adjust **B13 auto tilt switch** (Fig. 11) (optional: 2nd B15 at liftarm mounted. Fig. 12: wire facing down, when liftarm at bedheight) Don't forget the **secure latch** to avoid turning of sensor
- **B15 platform sensor wire** (Fig. 13) has to face down, when platform in closed position (alternatively: B16 platform switch mounted acc. Fig. 14 **Always remember to set strain relief!!!**)

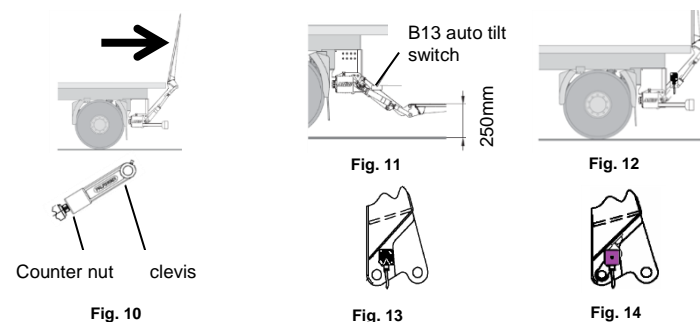

### 4. Platform installation

- Connect platform and **liftarm** with the pins (Fig. 8)
- If platform is shifted or off side, use our plastic **washers** to correct.
- Fully extend the **tilt cylinders** and connect it in a vertical upright platform position with the pins. (Cylinder clevis can be turned during mounting stage)
- Mount **accessory items** like rollers and safety screws
- If applicable, connect **platform control cable** w/ platform according drawing and stow it. Pay attention to the colour code (Fig. 9)
- Mount warning flags according to drawing on platform

